

Springfield CBC Commuter Parking Garage



Department of Transportation

Building Design and Construction Division



Springfield Community Business Center Commuter Parking Garage

Design Features

- Site improvements on existing 2.7-acre site
- 6-level precast garage with over 1,000 parking spaces
- Exterior wall systems include curtain walls, perforated metal panels, and a green wall
- LED lighting throughout with Solar PV on the top level
- Two commuter slug line loading zones
- Carpool waiting/short-term parking area
- Pedestrian bridge over Old Keene Mill Road
- Bus transit center with 7 bus bays
- Bicycle storage, passenger waiting areas, and transit system information
- Community event spaces on ground and top levels

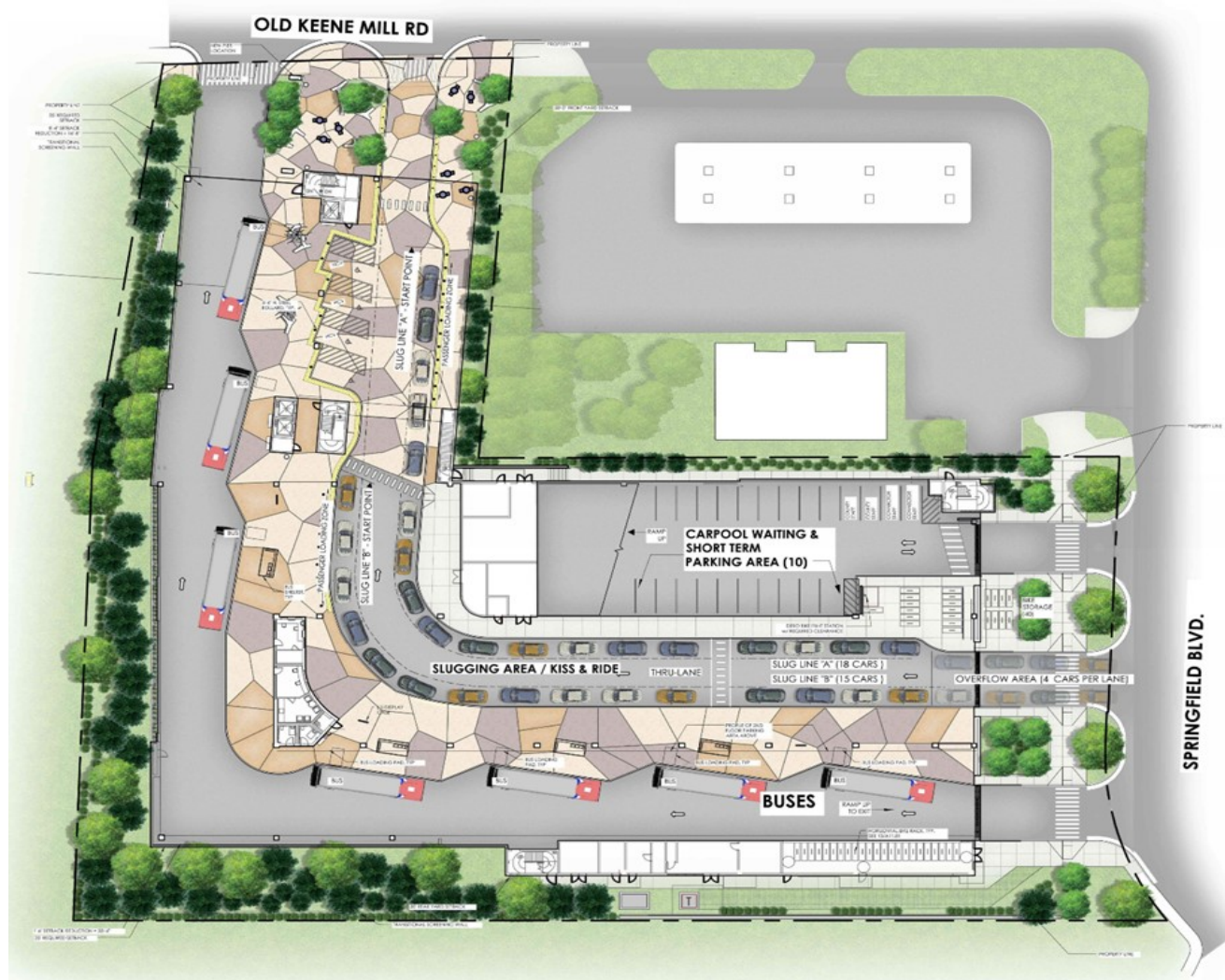

Springfield CBC Commuter Parking Garage

Ground Level



Roof Top View

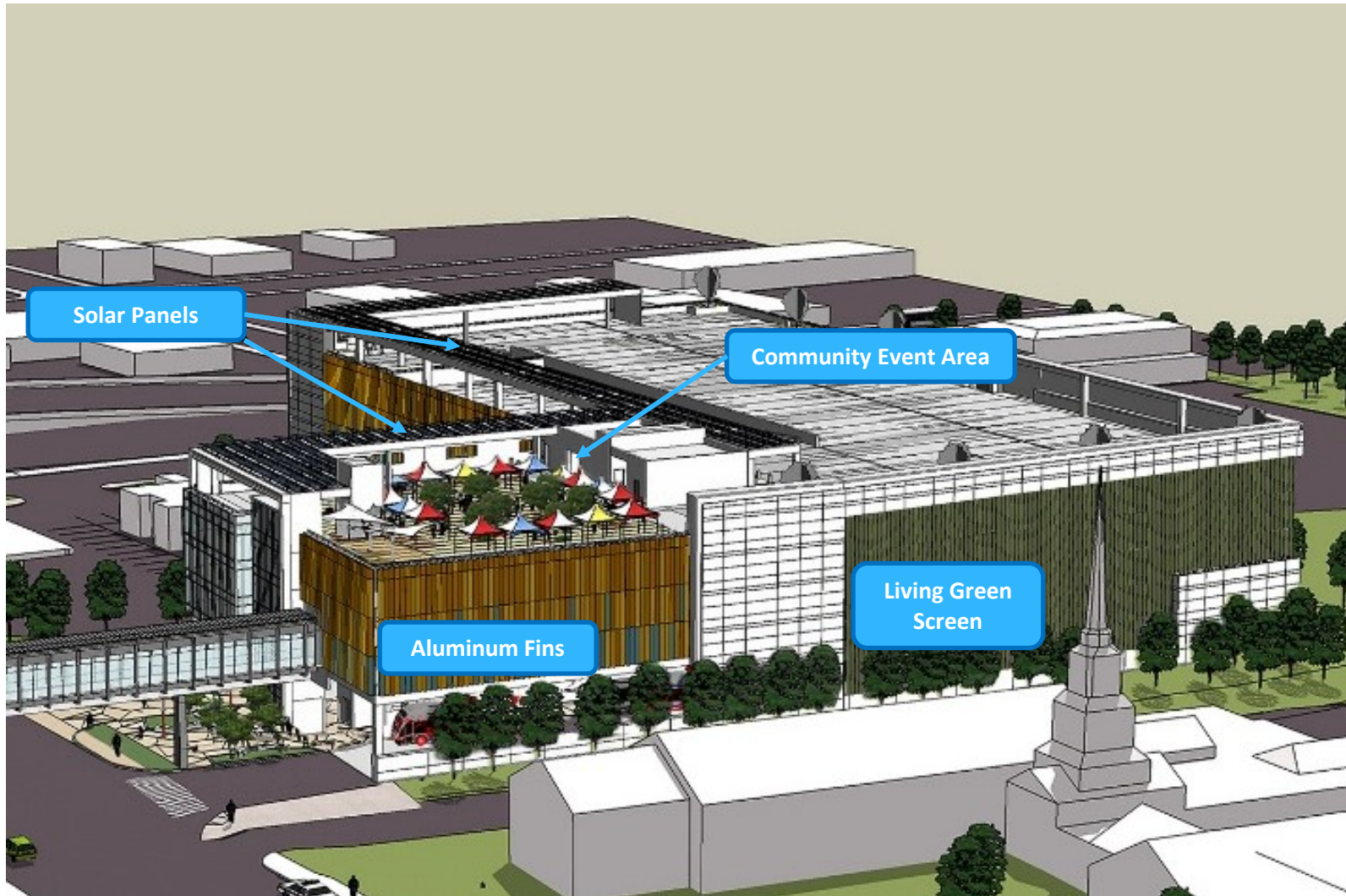

Street Level Perspective



Milestone Schedule

- Estimated Construction
- Estimated Opening

Spring 2021 to Summer 2023
Fall 2023

